



Assist Customer's Smartphone Remotely

Introduction

NOV. 5th 2010

Written by RSUPPORT MKT division

Index

1. Overview
2. RemoteCall?
3. Strong Point
4. about RSUPPORT

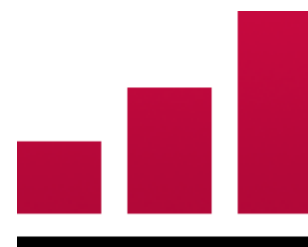

1. Overview

- Market Trends
- MDM
- Control Remote Smartphone
: Practical usage



63M Smartphones were sold in the 2nd quarter of 2010 - 50% increase over the previous year

Vendor	Q2 2010 Shipment Volumes	Q2 2010 Market Share	Q2 2009 Shipment Volumes	Q2 2009 Market Share	Q2 2010/ Q2 2009 Change
Nokia	24.0	38.1%	16.9	40.3%	42.0%
RIM	11.2	17.8%	8.0	19.1%	40.0%
Apple	8.4	13.3%	5.2	12.4%	61.5%
HTC	4.8	7.6%	2.1	5.0%	128.6%
Samsung	3.0	4.8%	1.1	2.6%	172.7%
Others	11.6	18.4%	8.6	20.5%	34.9%
Total	63.0	100.0%	41.9	100.0%	50.4%

Trouble Maker : Smartphone vs. PC

2010. 08.

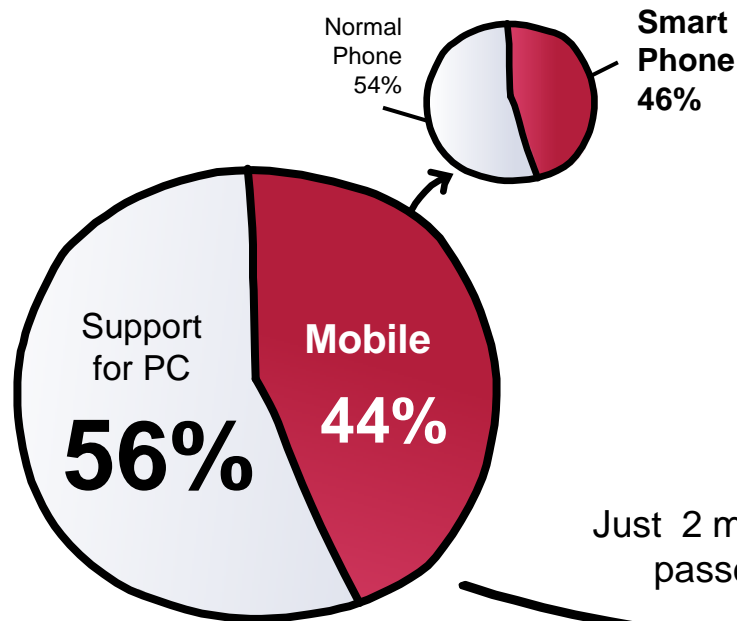

2010. 10.

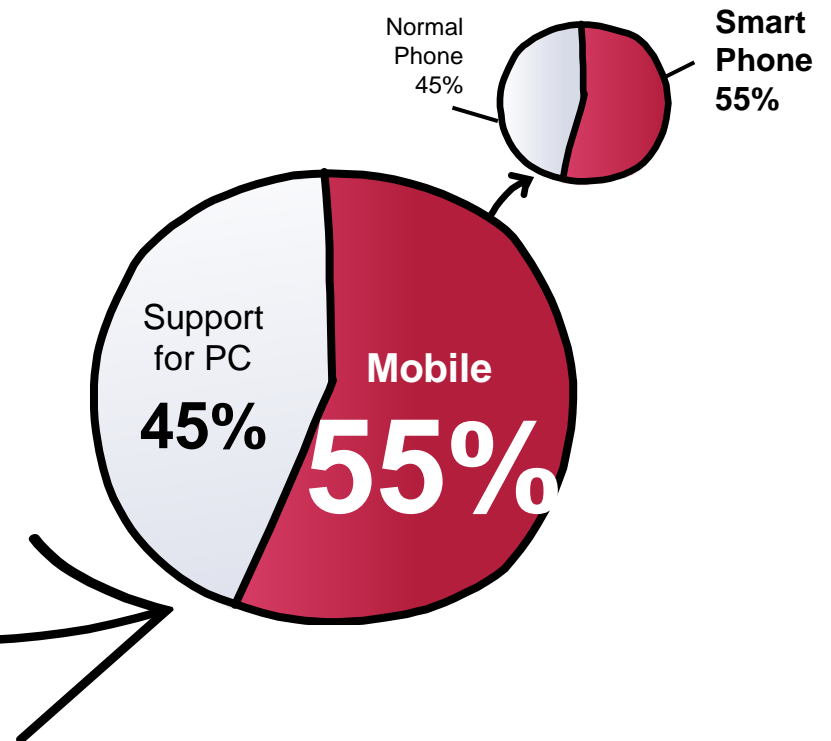

Just 2 months passed

* SOURCE : a very global electronic service company

More efficient solution for Mobile Devices



* SOURCE : a very global electronic service company

Mobile Device Management

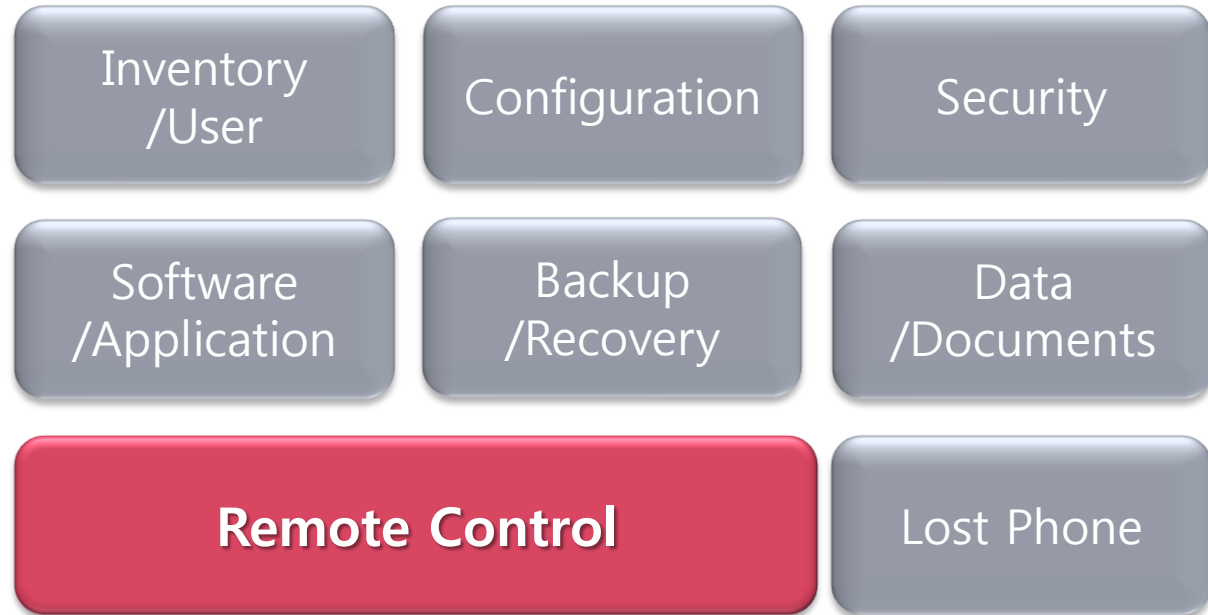

Practical Usage



Phone Manufacturer



Telco



Enterprise

Trouble
Shoot

Device
Management

Security
Management

2. RemoteCall?

- What is RemoteCall?
- Key Map
- Key Features
- Platforms
- Management / Operation



What is RemoteCall?

Real time support remote Smartphone, PC, TV ...

- Screen sharing
- Input (Touch, Button) control
- File transfers

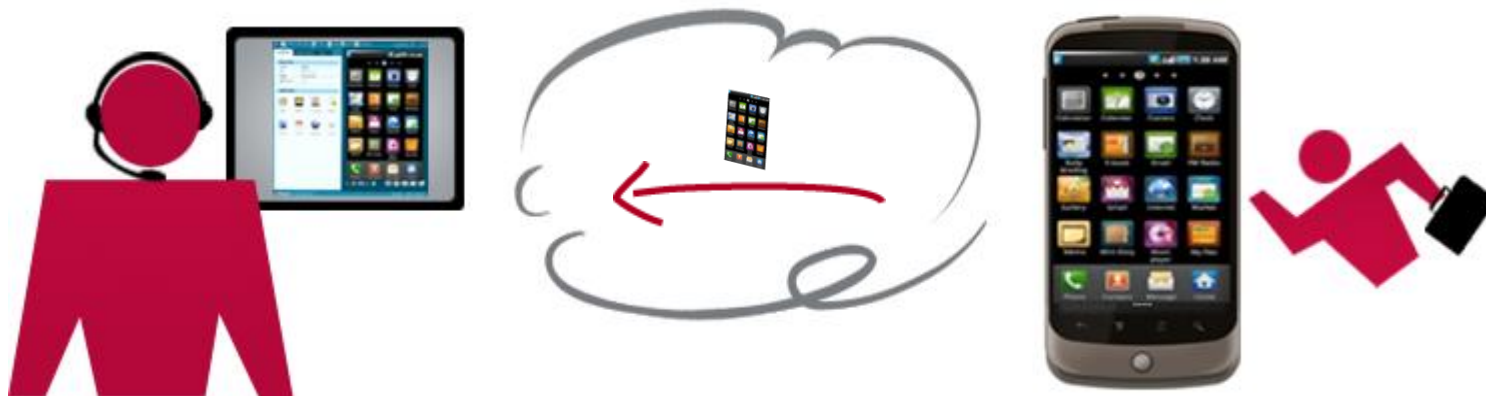

Key Map

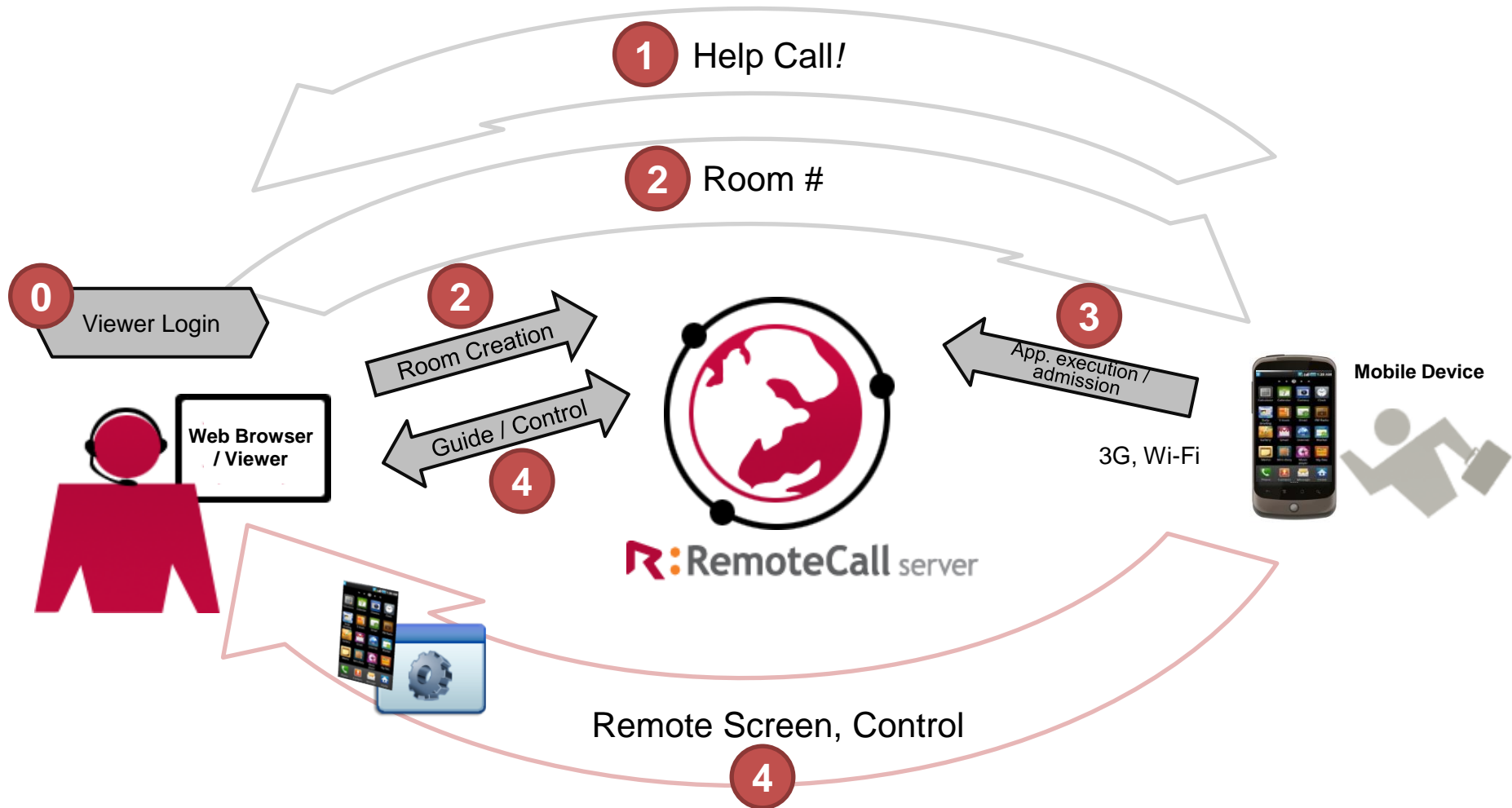

Screen Sharing

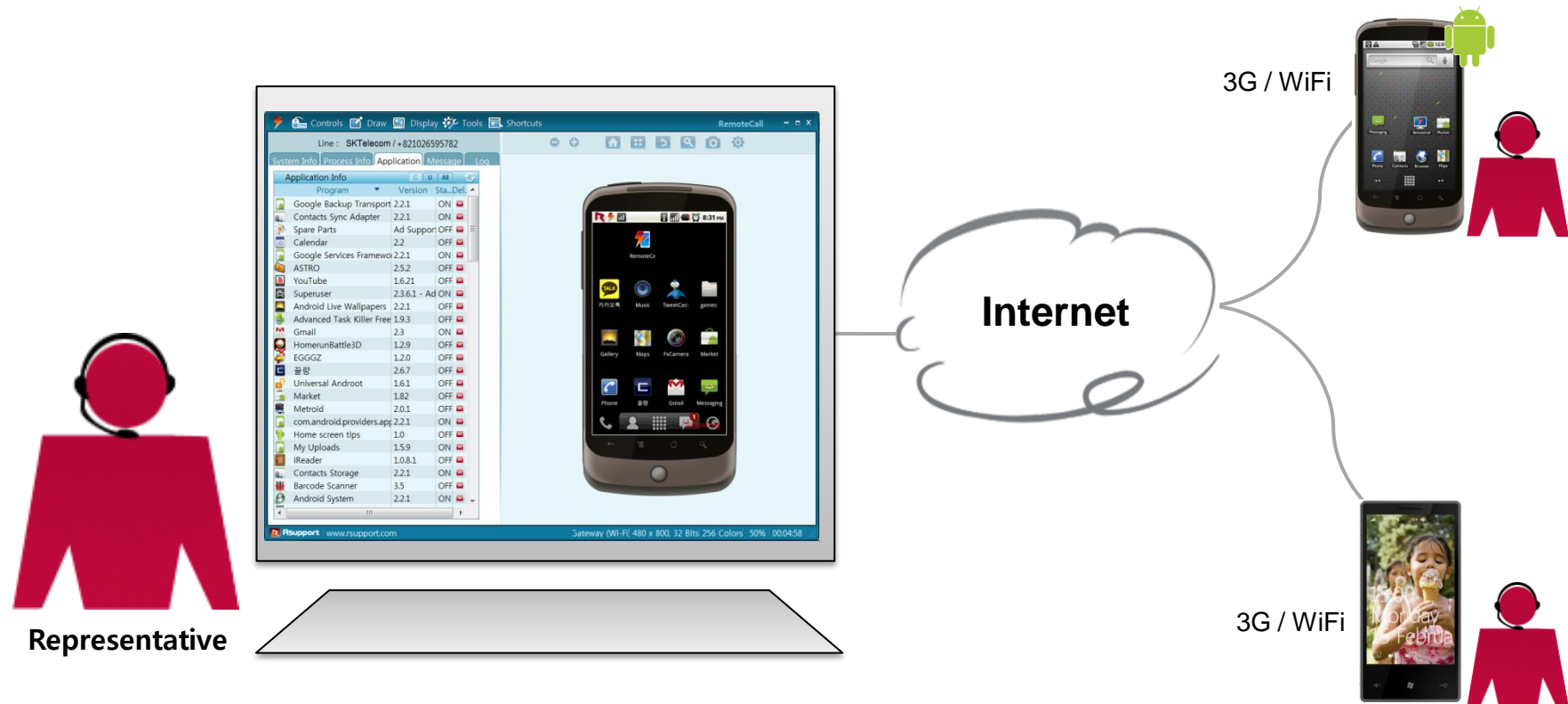

Session Transfer

Forward a session to another representative while it is connected with a customer : Professional advice, Multilateral collaboration and Education

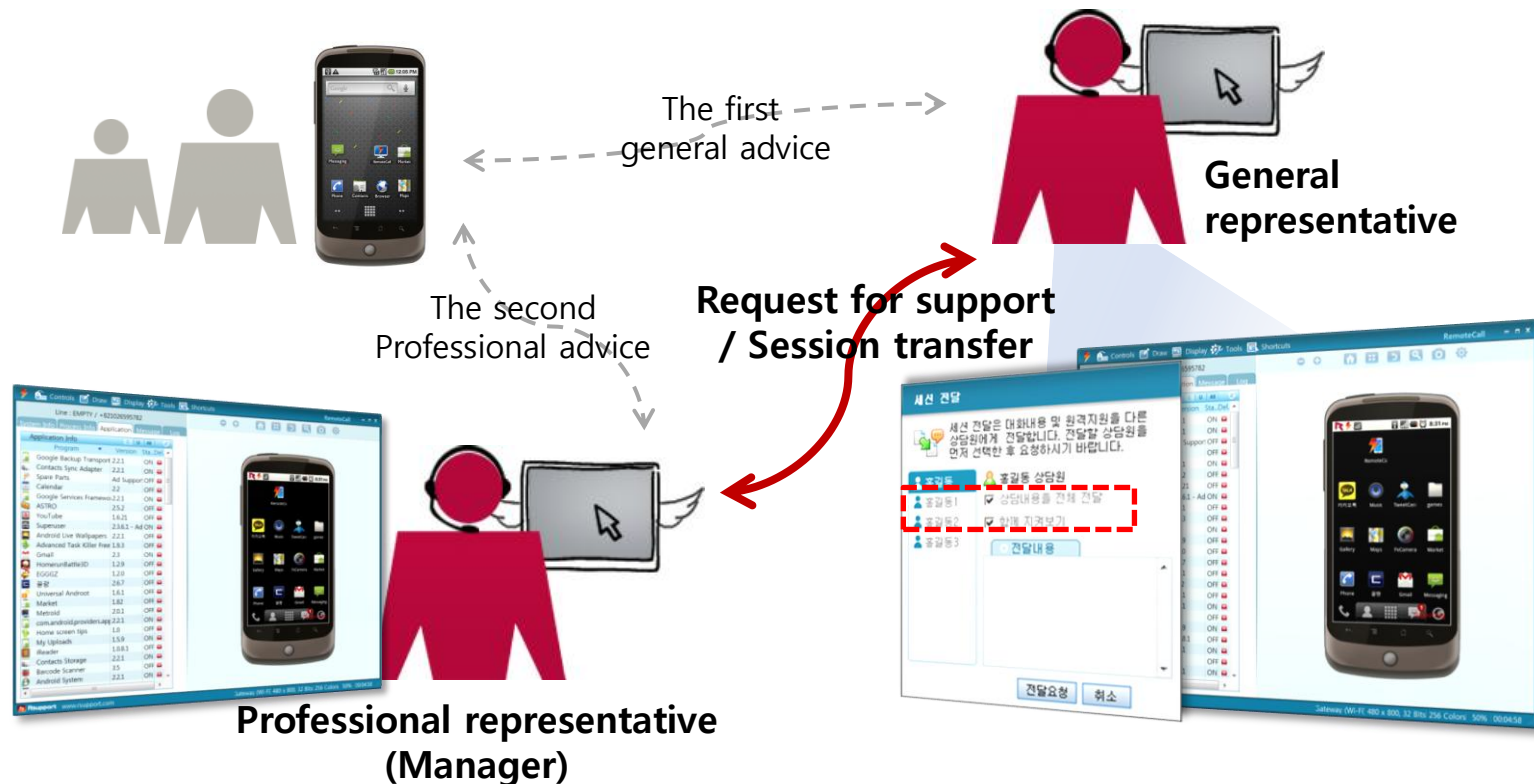

Device Information

The screenshot displays the RemoteCall application interface with two overlapping windows. The background window shows the 'System Info' tab, and the foreground window shows the 'Application' tab. Callouts highlight specific features:

- Device Information:** Points to the 'System Info' tab in the background window.
- Current Memory Status:** Points to the 'Application' tab in the foreground window.
- List of Process:** Points to the list of installed applications in the foreground window.
- Terminate Process:** Points to the 'Status' column in the application list.

System Info (Background Window):

General Info	
Phone Number	+821026595782
Line	EMPTY
Rooting	YES
Model	Nexus One
Firmware version	2.2.1
OS Version	2.6.32.9-ge8111ea
Battery	11%
Internal phone Storage	196MB(T) / 38.36MB(F)
SD Memory	14.83GB(T) / 13.80GB(F)
3G Signal Strength	100%
Wi-Fi Signal Strength	79%
Memory	385 MB(T) / 225 MB(F)
Serial Number	8982300610004950063

Application (Foreground Window):

Program	Version	Sta...	Del...
Google Backup Transport	2.2.1	ON	✖
Contacts Sync Adapter	2.2.1	ON	✖
Spare Parts	Ad Support	OFF	✖
Calendar	2.2	OFF	✖
Google Services Framework	2.2.1	ON	✖
ASTRO	2.5.2	OFF	✖
YouTube	1.6.21	OFF	✖
Superuser	2.3.6.1 - Ad	ON	✖
Android Live Wallpapers	2.2.1	OFF	✖
Advanced Task Killer Free	1.9.3	OFF	✖
Gmail	2.3	ON	✖
Home	1.2.9	OFF	✖
com.android.providers.app	2.2.1	OFF	✖
Home screen tips	1.0	OFF	✖
My Uploads	1.5	OFF	✖
iReader	1.0	OFF	✖
Contacts Storage	2.2	OFF	✖
Barcode Scanner	3.5	OFF	✖
Android System	2.2.1	ON	✖

The foreground window also displays a virtual Android phone screen with various app icons like 'RemoteCa', 'TALK', 'Music', 'TweetCast', 'games', '카카오톡', 'Gallery', 'Maps', 'PxCamera', 'Market', 'Phone', '캘린더', 'Gmail', and 'Messaging'.



Input Control

- Click, Drag
- Main buttons
 - Home, Menu,
 - Back, Search,
 - Volume Up/Down
- Skin is applicable



Guide

Guide customers by drawing on their screen without direct control the customer's device



Setting

Settings to Improve the performance

The screenshot shows the RemoteCall application window. The 'Settings...' option in the menu is highlighted with a red box. A red arrow points from this menu item to the 'Display Quality' dialog box. The dialog box contains settings for Network, Driver, and Color Depth. It includes sliders for 'WIFI Color' and '3G Color', both set to '256 Color', and a 'Display' slider set to 'Low'. The status bar at the bottom shows 'Gateway (Wi-Fi) 480 x 800, 32 Bits| 256 Colors 50% | 00:12:34'.

Application	Message	Log
Version	Sta...Del.	
Support	2.2.1	ON
Computer	2.2.1	ON
Ad Support	2.2	OFF
Google Services Framework	2.2.1	ON
ASTRO	2.5.2	OFF
YouTube	1.6.21	OFF
Superuser	2.3.6.1 - Ad	ON
Android Live Wallpapers	2.2.1	OFF
Advanced Task Killer Free	1.9.3	OFF
Gmail	2.3	ON
HomerunBattle3D	1.2.9	OFF
EGGGZ	1.2.0	OFF
꿀랑	2.6.7	OFF
Universal Androot	1.6.1	OFF
Market	1.8.2	OFF
Metroid	2.0.1	OFF
com.android.providers.ap...	2.2.1	ON
Home screen tips	1.0	OFF
My Uploads	1.5.9	ON
iReader	1.0.8.1	OFF
Contacts Storage	2.2.1	ON
Barcode Scanner	3.5	OFF
Android System	2.2.1	ON

RSupport Configure the default connection settings. Gateway (Wi-Fi) 480 x 800, 32 Bits| 256 Colors 50% | 00:12:34

Recording (optional)

- Reserved Recording server
- A central control
- All the screen change
- Reserved format
- Dispute prevention
- Educational use

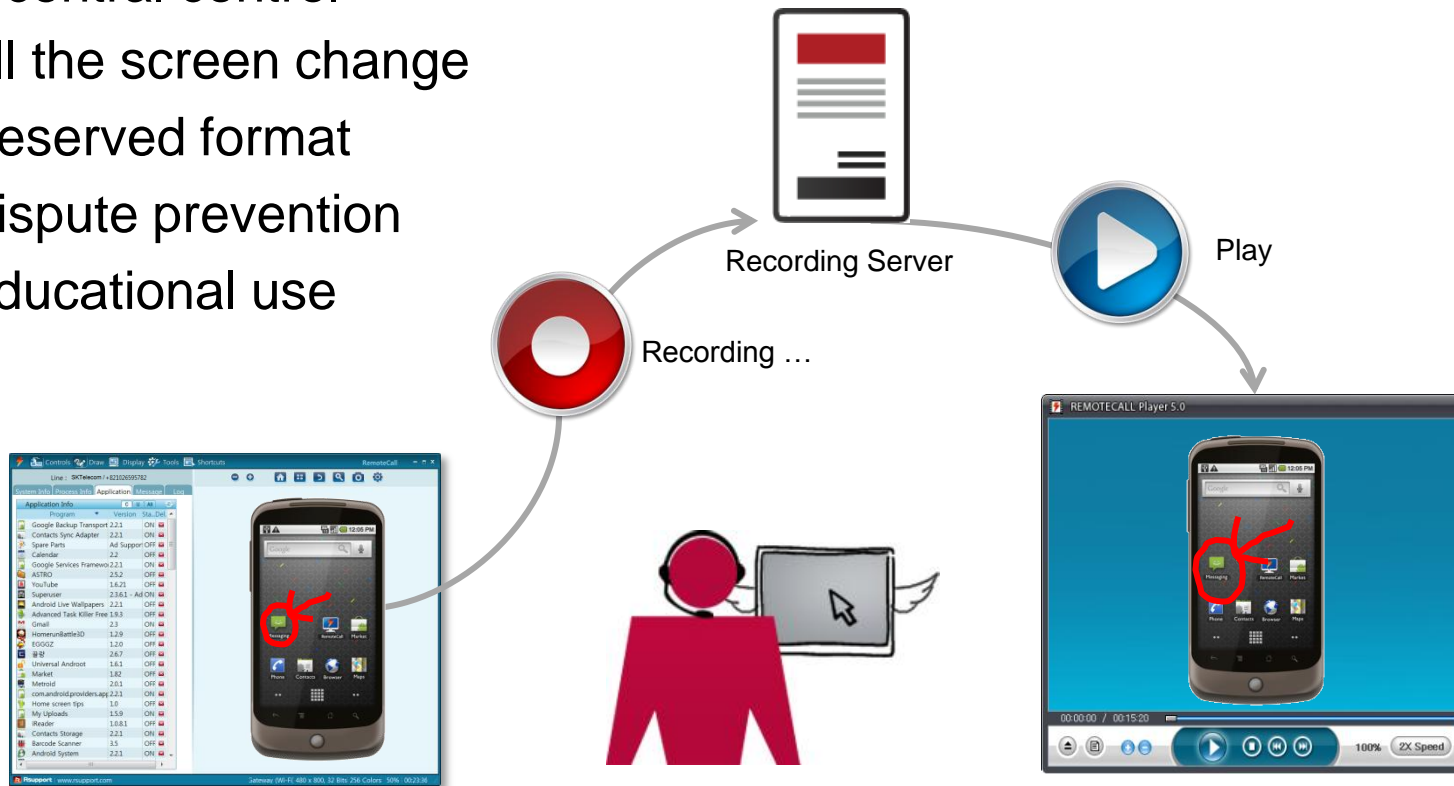

RemoteCall is ready for various platforms

Customer



Android 2.1/2.2



**Windows
Mobile 6.x**



**Windows
Phone 7**



Representative



Windows



Mac OS X



Linux

Planned

System Configuration

- Authentication and Relay server.
- Relay server can be distributed in different places to improve the performance.

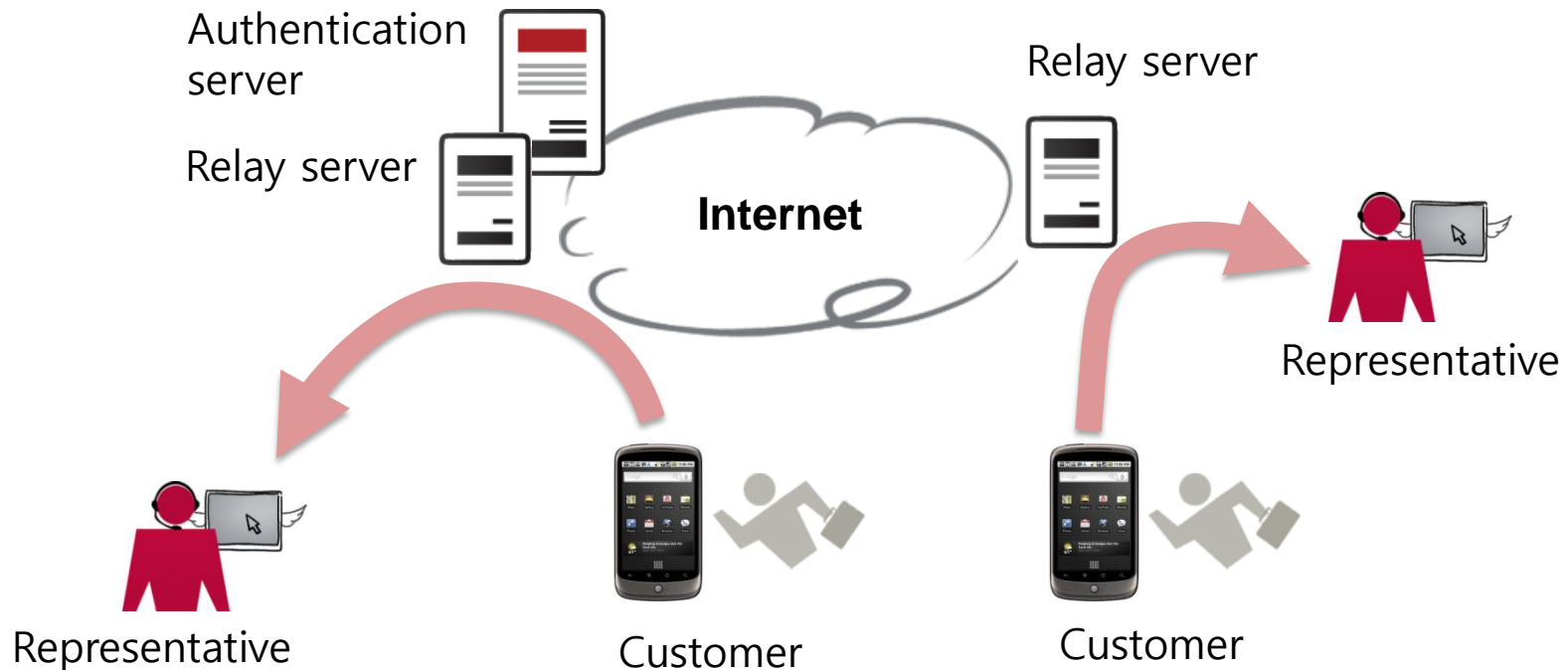

3. Strong Points

- Key Issues
- Installation
- Performance
- Connection
- More

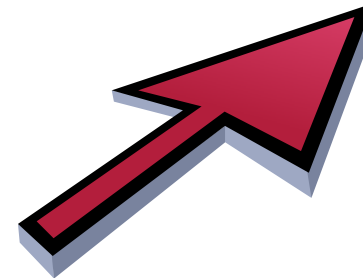

Key Issues

- Mobile App Install
- Traffic
- Connection
- Load
- Session



How to install our app to Smartphone

- Embedding – Factory Installation
 - Pre Porting
 - OS Upgrade
- App Download*
 - Signed APK by System Key
 - SMS Linker
 - Market
 - Mobile Web



* Requires OS Acceptance

Engine

▪ Mirror Video Driver Type

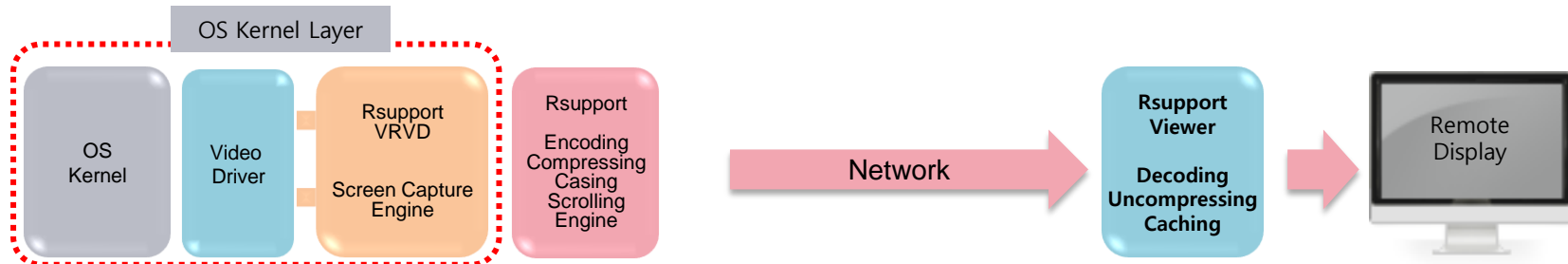

▪ Advanced Polling Screen Type

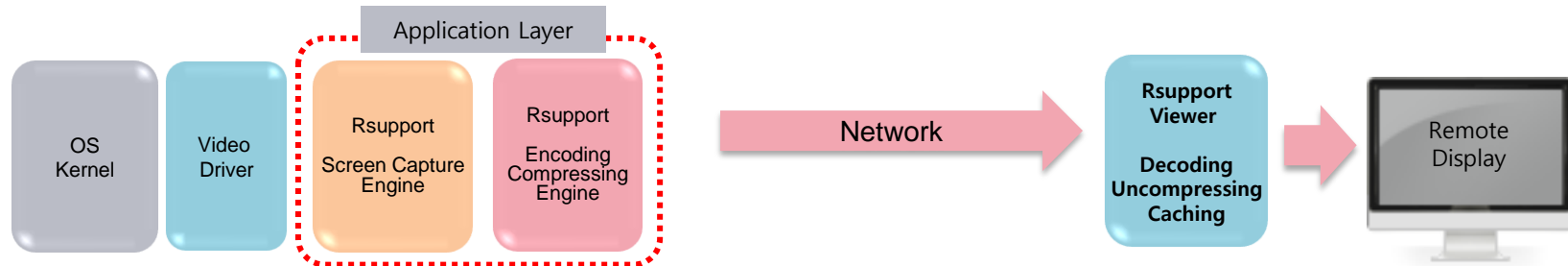

▪ System Hooking Type

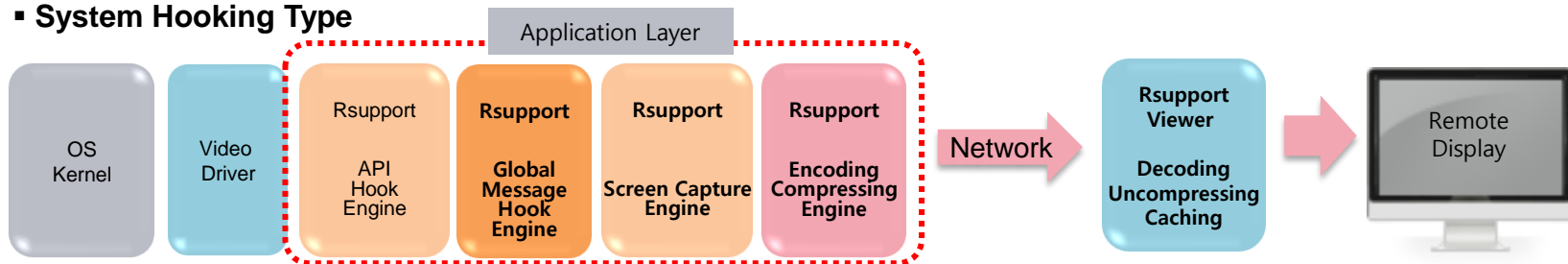

Engine

Type	Minimum CPU Spec	CPU Usage	Data Packet Size	Extracting Data Process	DirectX 3D	Programming	Control Speed
Mirror Driver	Low	Low	Low	Short	None	High Skilled	High
Polling Screen	Medium	Low & Medium	Medium	Short	Yes	Very Simple	Medium
Hooking	High	Medium	High	Long	Yes	High Skilled	Medium

Process

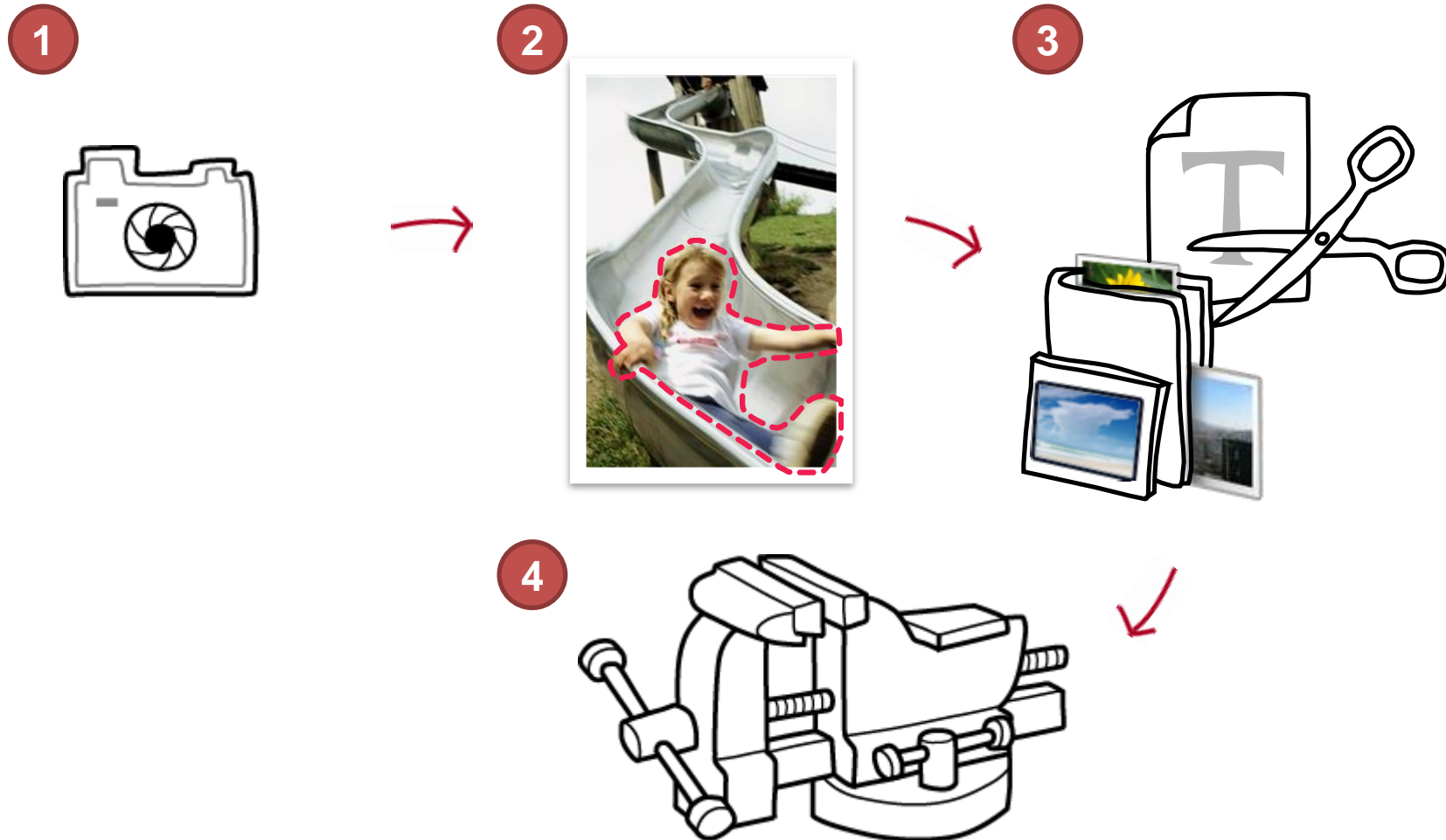

Process

Transferred screen



Item	Description
1	<ul style="list-style-type: none"> - Screen image compression/transfer - True Color -> 256/64/4 Color Change
2	<ul style="list-style-type: none"> - Texts and images on the screen are transferred separately.
3	<ul style="list-style-type: none"> - Only changed areas on the screen are transferred
4	<ul style="list-style-type: none"> - Rapid return to current display : Image caching - 10KB >

Process

Low Bandwidth(3G) Packet reduction Algorithm

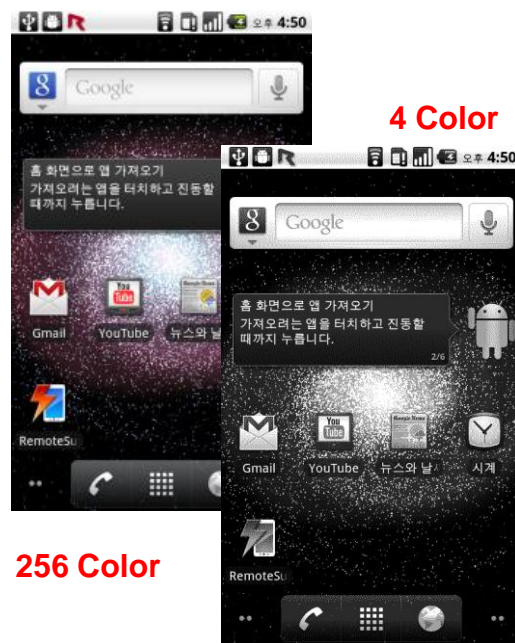

Screen is changed
in less than 2 sec.



Omit
Unnecessary
screen
components



Move to 'Set up' via
'Home' screen

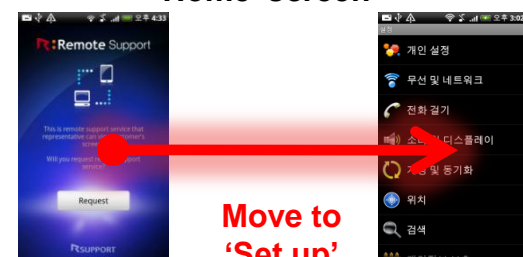

Move to
'Set up'
directly

Automatic color adjustment

Automatic color adjustment (256/64/4) as
Network speeds

Unnecessary screen is not transferred

The screen which is changed in less than 2
sec. would be omitted during the screen
transfer

Move to 'Set up' immediately

After the connection, you can see the main
screen directly without any unnecessary
screen

Benchmark

Scenario of screen changing

1. Main screen → 2. Program → 3. E-Mail

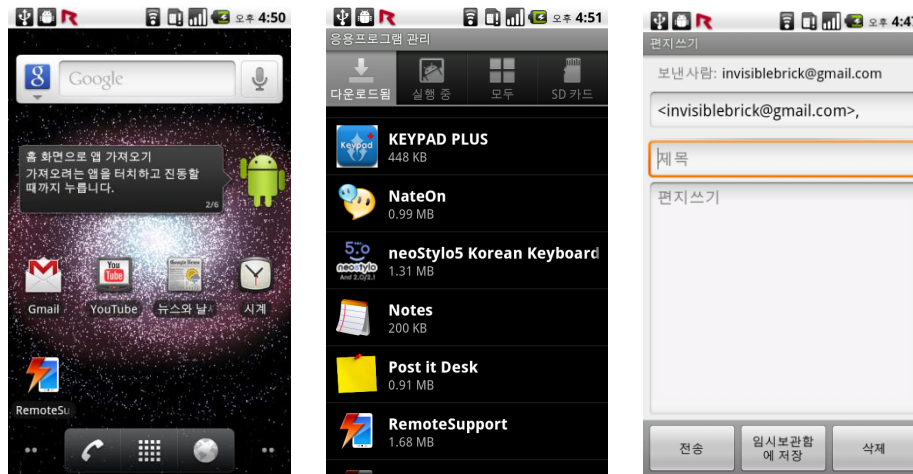

Test phone : Galaxy S
Original resolution : 800*480
Color: 16 bit

Normal 256Color :
Data size is reduced by about 27 times

1) Customer moves lateral three screens 1 time (Kbyte)

Class.	True	256	64	4
Original	2250			
Transferred	473	145	82	41
Reduced	79%	93.6%	96.4%	98.1%

2) Expected speed of Data transfer as the above result (sec.)

Uploading	True	256	64	4
50Kbps	75	23.2	13.1	6.5
500kbps	7.5	2.3	1.3	0.6
1Mbps	3.25	1	0.7	0.3

3) If customer repeats above action of "1)" 3 times (Kbyte)

Class.	True	256	64	4
Original	6750			
Transferred	572	250	142	61
Reduced	91.5%	96.3%	98.9%	99.1%

* Reduced data packet size : 11 (True) ~ Max. 110 times (4color)

Type

- 3G
- WiFi
- USB Cable through PC
 - No Install
 - No Rooting

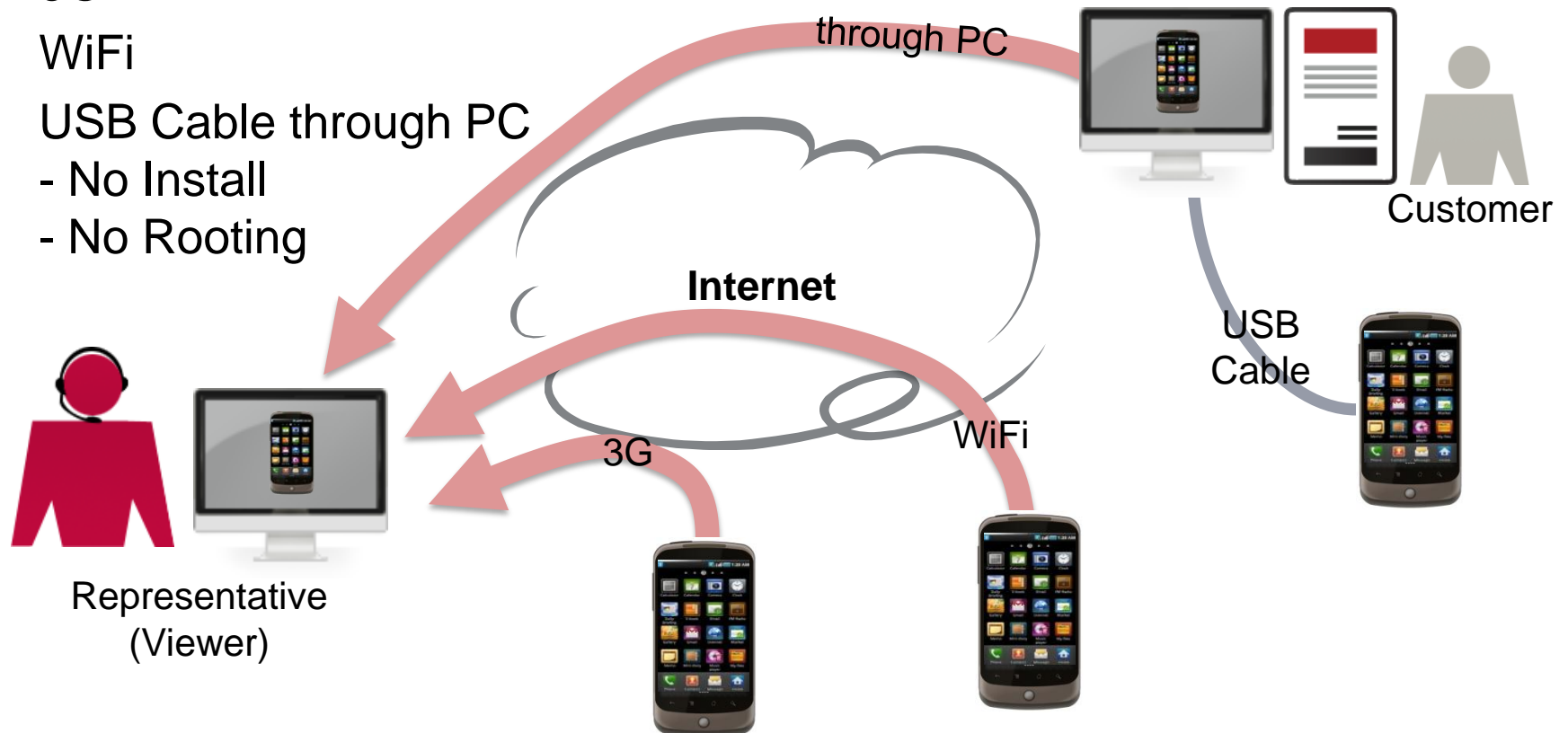

Process

- Pin Code
 - 6 digit code
- One Click
 - Customer's Phone No.
 - A patent application Feature

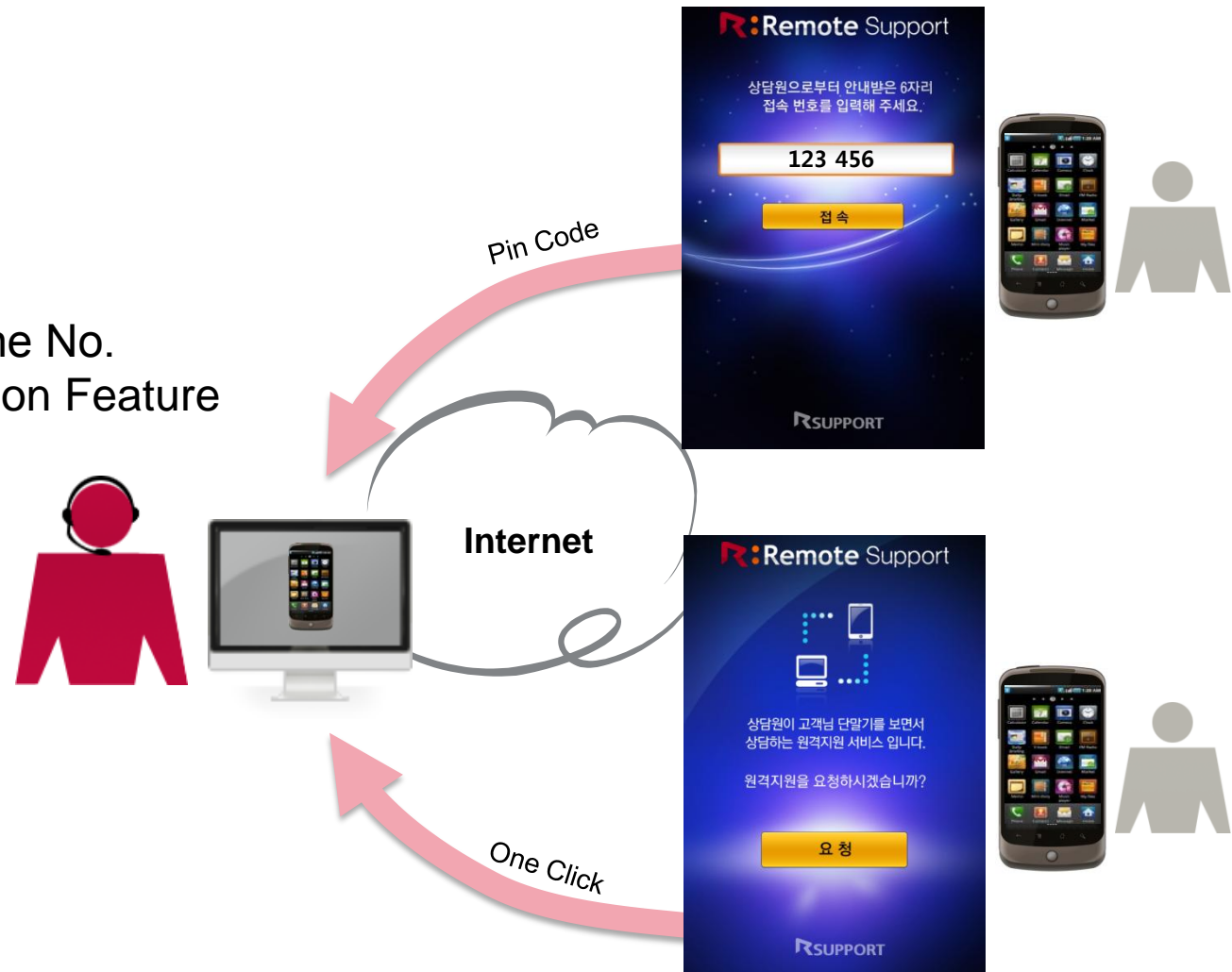

Keep Session

Low Bandwidth(3G) Packet reduction Algorithm

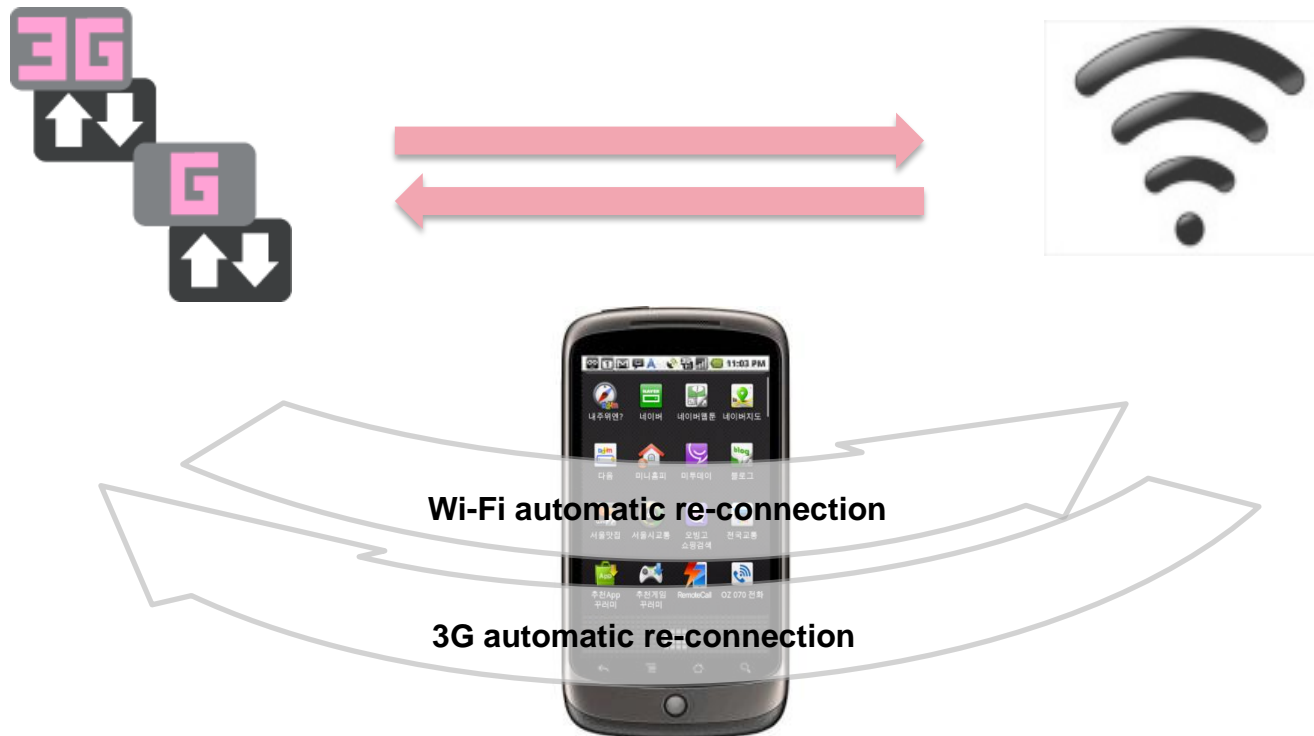

Light Load

Item	Content	Remarks
Minimum requirement for the device	Android 1.6 and high	
Network	Internet accessibility	3G, Wi-Fi, USB
Device client size	1 Mbytes plus	
RAM Size for operation	300 Kbytes plus	
Device client operation time	About 1~2 seconds	Depends on a device
Remote connection time	About 10 seconds	Depends on Internet environments
Device's CPU usage	2~30%	Depends on a device
Transferred data size between client devices to server	About 2,731 bps	Depends on screen contents
Communications protocol	TCP/IP	

4. about RSUPPORT

- Overview
- Present condition
- Patents and Certifications
- History
- External evaluation
- Major business and service area
- Best Practice on Mobile



RSUPPORT is the world leader in remote solutions purpose-built for the call center and helpdesk of business, education, government and service providers. Our reliably engineered, easy-to-use products service over 5,000 companies to assist the remote users all around the world.

Offices : Korea, Japan, US, China
Contact : +82.70.7011.0590

Established in 2001

Employees: 98

Specialized in Remote Solutions only

No. 1 in Korea

No. 1 in Japan

No. 1 in Asia

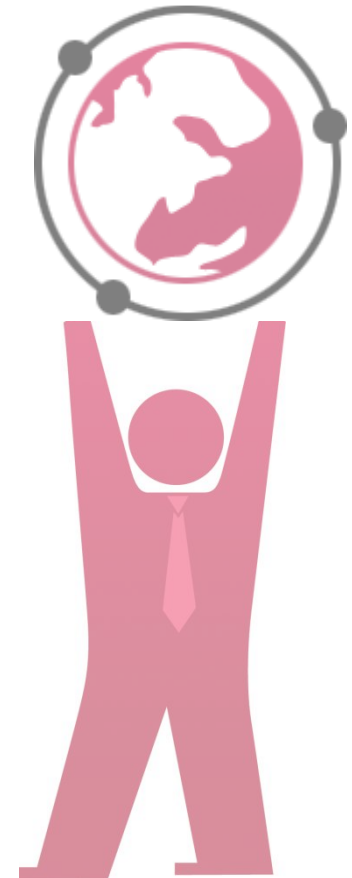



2005 Korea Software Award
- Minister Award
- Organization MIC
- 2004 Dec.



100 Excellent Patent software
- Minister Award
- Hankook News Award
- 2004 Jul.

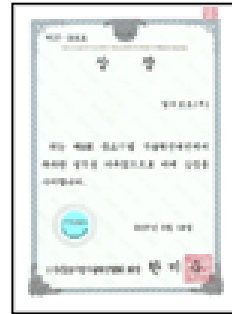

Innovative Technology
- SMB Technology Association
- Organization SMBA
- 2007 Sep.



Venture Company Award
- SMB Committee
- Organization MKE, KOVA
- 2007 Oct.



New Software
- Minister Award
- 2004 Jul.

Prospected Export Company
- Organization SMBA
- 2003 Dec.

Venture Company
- Remote Support Technology
- Organization SMBA
- 2003 Dec.

Transparency Management
- Organization KIBO
- 2005 Aug.

R&D Center Certificate
- Organization KIAT
- 2007 Jul.

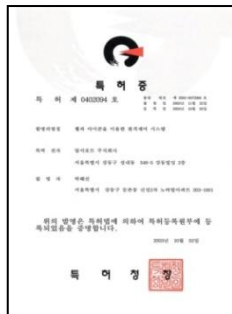

Patent No. 0402094
- Remote Control System
using Web and Icon
- Issued : 2002.11.22



JP Patent No. 4038684
- Remote Control System
Using Web and Icon
- Issued : 2003.11.19



Patent No. 0014773
- File transfer System
through gateway server
- Issued : 2002.3.19



Patent No. 10-0676865
- Computer Remote
Control Method using
ARS and Internet
- Filing : 2005.12.15



Patent No. 10-0817767
- Authentication Method
using icon code
- Issued : 2008.01.14

Certificate of Software Quality
- Number : 04-0044
- Program : RemoteCall v3.1
- Date : 2004.12

Certificate of Software Quality
- Number : 06-0034
- Program: RemoteCall v4.0
- Date : 2006.02

Certificate of Superior
Technology Company
- Date : 2002. 12.26
- Korea Technology Credit
Guarantee Fund
Works with Windows Vista
- Program : RemoteCall
- Date : 2007.04

Establishment of RSUPPORT Co., Ltd.

Patent : Remote control system using web and icon in Japan
Supply RemoteHelp to US army

Launch RemoteCall v3.0 Service
Patent : Remote control using web and icon
Supply remote support service to HANARO Telecom, Korea

Launch RemoteCall v4.0 Service
Supply RemoteCall to Toshiba, Japan
Supply RemoteCall to NTT Data as OEM

Supply Kidscare service to NTT, Japan
Launch SK Telecom MyPC service
Establish US office (in New York)
Establish China office (in Beijing)
Launch RemoteView 5.0 Server

Supply RemoteCall + mobile pack service to POSCO
Supply RemoteCall + mobile pack service to NTT-DoCoMo
Supply RemoteCall + mobile pack service to Samsung Electronics
Supply RemoteCall + mobile pack service to LG Electronics
Supply RemoteCall + mobile pack service to KT

No. 1 Remote Support KOREA

JAPAN

ASIA

No. 1 Remote Support Mobile

2001

2002

2003

2004

2005

2006

2007

2008

2009

2010

2011

PC

Launch Web based remote support service
Venture Company certification (SMBA)
Supply Remote Support Service to ANNET, Japan

Silver Award in Top 100 good patent (KIPO)
Patent : File transfer system through gateway server

Establish Japan office (in Tokyo)
Supply RemoteCall service to SONY, Japan
Supply RemoteCall service to FUJITSU, Japan
Supply RemoteCall service to RICOH, Japan
Supply RC Helper and distributor contract with NEC
Launch RemoteView Mobile Service
Win the million-dollar-exportation award

Mobile

Launch RemoteView Mobile 2.0
Patent : Authentication method using icon code
Launch RemoteCall 5.0
Launch RemoteView 2.0 for PDA.

iPhone

Android

Launch remote support for Mobile (Android Phone)
Supply RemoteCall + mobile pack service to SK Telecom(Galaxy S)
Launch RemoteView for iPhone
Venture Corporate Award : Prime minister citation
WRI(World Resources Institute) MOU
Supply RemoteCall service to LENOVO, China

RSUPPORT is one of the leading companies in the remote access and remote support market. Global research firms, IDC, Frost & Sullivan, and MIC Economic Research Center reported that RSUPPORT's remote support solutions are "No.1" in the Asian market.

Japan Market Sales (in Million dollar)



Web-based Clientless Remote Support Software :
Market Shares by Revenues(APAC),2008

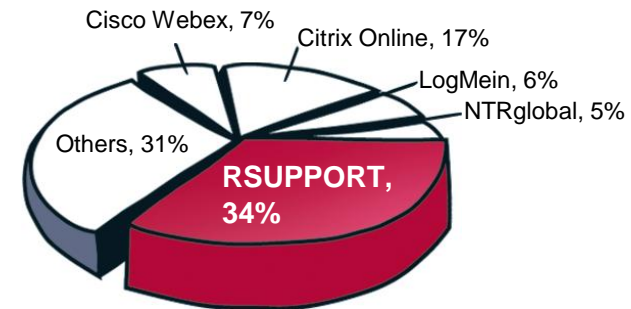

Note : All figures are rounded Source :
Frost & Sullivan

Online remote support
Service



R:RemoteCall

Online virtual
Helpdesk



R:RemoteHelp

Online Sales assistant
tool



R:RemoteSales

Personal remote-PC
control tool



R:RemoteView

Messenger Add-on



R:RemoteX

H/W all-in-one type
Remote support
solutions



R:RemoteCall appliance

API for other
application

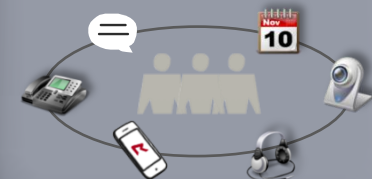

R:RemoteAPI



- SK telecom Smartphone remote support service
- November, 2010
- SK telecom Android Smartphone
- Support remote Smartphone as a customer service by SK telecom's call center

Function	Description
Device information	Display the device and user information to a representative
Program information	Display all applications which are installed and running on the smartphone, and the Representative can remove or end them
RF information	Information on the base station of customer's current location and performance quality are displayed
Firmware upgrade	By Device Management server
Remote support	Representatives solve customer's problem by seeing the Smartphone directly



For more information about RSUPPORT,
please visit <http://www.rsupport.com>

Korea :

(138-724) 서울시 송파구 방이동 45번지 한미타워
15층, 16층
전 화 : +82-70-7011-3900
팩 스 : +82-2-479-4429
기술문의 : support.kr@rsupport.com
구매문의 : sales.kr@rsupport.com
기타문의 : info.kr@rsupport.com

Japan :

〒100-0013 東京都千代田区霞ヶ関3-3-2
新霞ヶ関ビル18階KOTRA
TEL : +81-3-3539-5761
FAX : +81-3-3539-5762
お問い合わせ : support.jp@rsupport.com
Sales : sales.jp@rsupport.com
Info : info.jp@rsupport.com

USA :

142 West 36th Street, Suite 1008,
New York, NY 10018
Phone : +1-888-348-6330
Fax : +1-888-348-6340
Tech : support.us@rsupport.com
Sales : sales.us@rsupport.com
Info : info.us@rsupport.com

China :

北京市朝阳区东三环北路丙2号
天元港中心B座1005室
联系电话 : +86-10-8256-1810
传真号码 : +86-10-8256-2978
技术咨询 : support.cn@rsupport.com
销售咨询 : sales.cn@rsupport.com
其他咨询 : info.cn@rsupport.com